

TYPE R CIVIC
RR3
ENJOY RACING

J.A.S.
MOTORSPORT



無限 MUGEN

Honda Racing

CIVIC TYPE R

“This Type R Rally is a formidable piece of motorsport engineering, little wonder the JAS has build up a ten years long relationship with Honda and has earned the Japanese’s company implicit trust”

(CAR ONLINE – U.K. April, 2007)

Dimensions / Capacities (Gr.R)

- Wheelbase.....2630 mm
- Track Width FR/RR...1512/1535 mm
- Overall length.....4270 mm
- O/all width (FR/RR)..1760/1785 mm
- O/all height.....1400 mm
- O/hang (FR/RR).....850/790 mm
- Weight (Gr.R).....1080 kg
- Weight distribution F/R.....65%/35%
- Fuel capacity.....57 liters



1. BODY SHELL AND ROLL CAGE

- ◇ Seam welding of body panels
- ◇ TIG welded roll cage in Chrome-Molybdenum steel, complying with FIA 2006 rules.
Broad use of cross bracing tubes (sides, floor, main hoop, rear) and gusseting for maximum stiffness.
- ◇ Roll cage homologation by MSA-UK
- ◇ Painting: donor car original colour.

OPTIONS:

- JAS colours (white/grey)
- Customised painting
- Works car bodyshell

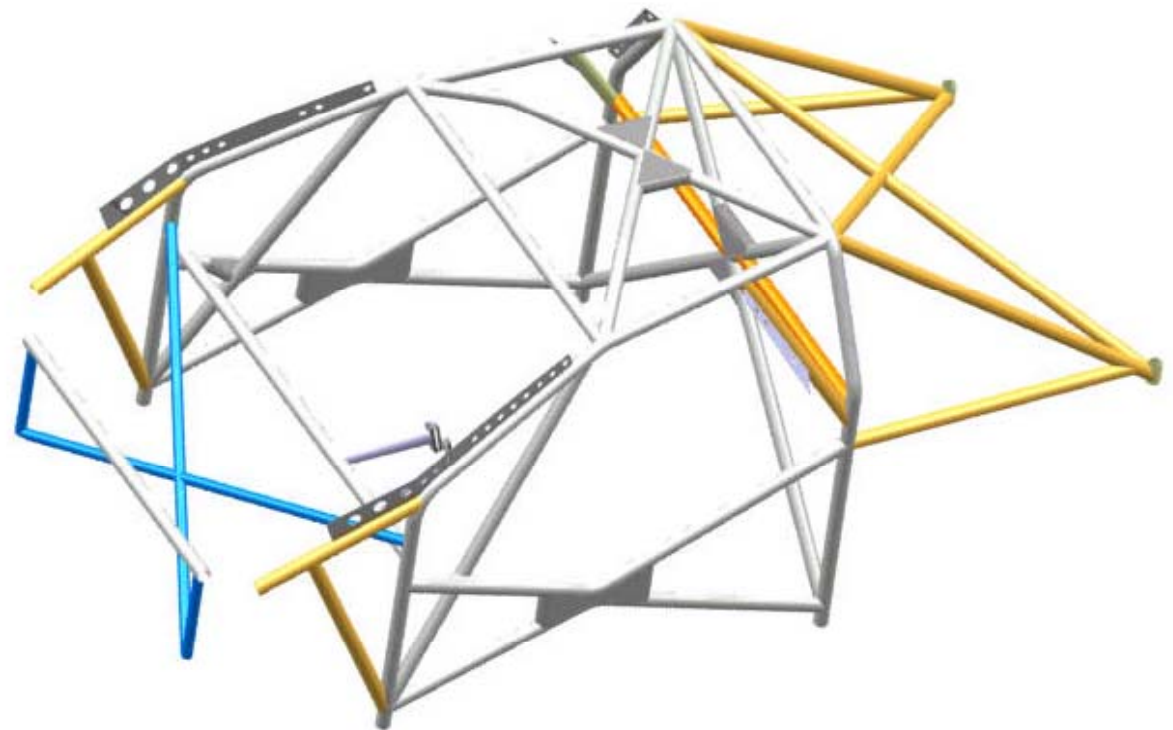

CIVIC TYPE R

2. ENGINE and ENGINE SYSTEMS

Engine development by MUGEN, official partner of JAS Motorsport.

Top power 260 HP at 8300 RPM, max torque 24 kgm at 6000 RPM

Engine rebuilding recommended between 1500 and 2000 km of SS
Average cost of rebuilding: 7000 euros

- ◇ Pro Competition camshafts (VTEC and VTC are maintained)
- ◇ Upgraded pistons
- ◇ Lightweight flywheel (4 kg)
- ◇ Competition exhaust pipe and cat converter
- ◇ Upgraded engine mountings
- ◇ Oil cooler
- ◇ Oil circuit upgrading,
- ◇ Balancing shafts removal
- ◇ Oil baffling in sump
- ◇ Competition air filter
- ◇ Carbon fiber air filter box
- ◇ Customised engine mapping

OPTION 2008:

- Heavy duty, forged, racing pistons (for "tough" downshifters!!!)

無限 MUGEN



CIVIC TYPE R

3. TRANSMISSION

- ◇ Custom-made six speed sequential gearbox (SADEV)
- ◇ Final drive ratio to be chosen among available options (top speed 160-180-195 km/h)
- ◇ Limited slip differential (plate type, adjustable preload)
- ◇ Twin discs, ALCON clutch assembly
- ◇ Upgraded drive-shafts and CV joints
- ◇ Automatic gear-cut ("flat-shift")

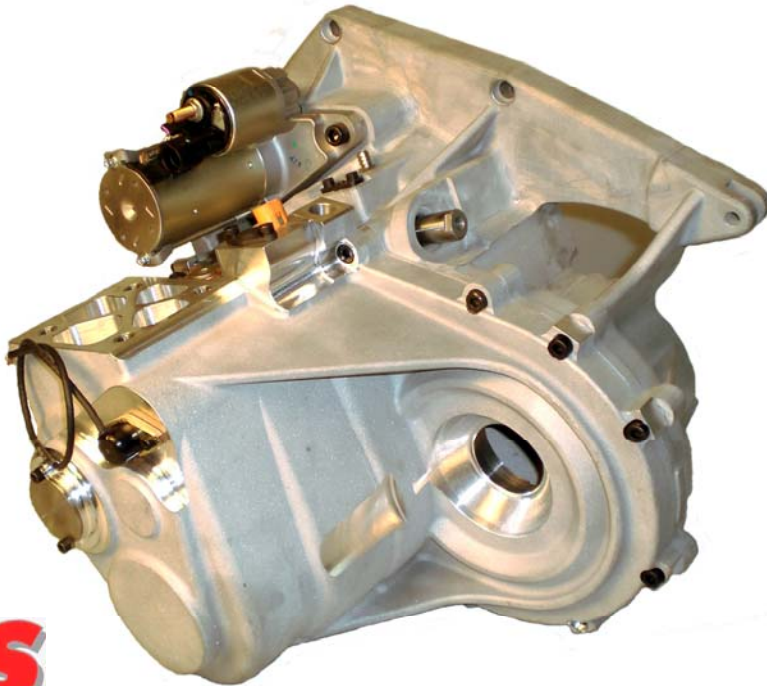

J.A.S.
MOTORSPORT



CIVIC TYPE R

4. SUSPENSIONS AND STEERING

- ◇ EIBACH Racing springs + helper springs
- ◇ EXTREMETECH RACING shock absorbers,
 - three ways adjustable
 - 55 mm tube front strut
 - adjustable spring plate.
 - Competition FR and RR ball joints mountings
- ◇ All suspension rubber joints replaced by ball joints
- ◇ 3-positions adjustable, upgraded FR antiroll bar
- ◇ Upgraded RR twist beam with integrated stiffer antiroll bar
- ◇ Hydraulic power steering box
- ◇ Upgraded front knuckles (bigger wheel bearing)

OPTIONS

- ◇ EXTREMETECH shock absorbers for gravel
- ◇ HEAVY-DUTY front suspension (lower wishbone)
- ◇ Selection of front and rear anti roll bar stiffness

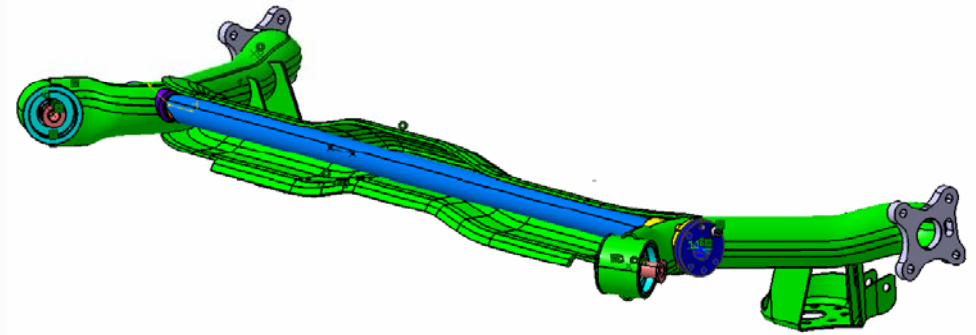

J.A.S.
MOTORSPORT



5. BRAKES

- ◇ BREMBO Racing front calipers, 4 pots (diam.40/44 front)
- ◇ Front discs BREMBO, ventilated 328x32 mm, mounted on floating disc-bell
- ◇ Rear discs BREMBO, drilled 278x6.5 mm, mounted on floating disc-bell
- ◇ JAS Design double-master-cylinder brake pedal, adjustable brake balance
- ◇ FERODO DS 3000 FR and DS 2500 RR brake pads
- ◇ AP pressure reducer
- ◇ Hydraulic fly-off hand brake

OPTIONS

- ◇ Ventilation ducts (bumper side) in composites
- ◇ Front brakes for gravel (4 pistons caliper + 300 mm disc)
- ◇ Rear discs BREMBO, drilled/plain 278x6.5 mm



CIVIC TYPE R

6. COCKPIT

- ◇ Carbon/fiberglass floors (driver and co-driver)
- ◇ Front and rear carbon/fiberglass door panels
- ◇ Carbon/fiberglass dashboard panels
- ◇ Carbon/fiberglass switch panel on dashboard
- ◇ Carbon/fiberglass switch panel on tunnel
- ◇ Carbon/fiberglass fuel-tank-opening cover on console
- ◇ SPARCO 6-points, 3" seat belts, for HANS use
- ◇ SPARCO PRO WRC Racing Seat (fiberglass)
- ◇ SPARCO steering wheel – diameter 345 mm
- ◇ Co-driver footrest, handy fire ext. support
- ◇ Anti-reflex (velveting) coating on dashboard

OPTIONS

- Heated windscreen
- Air scoop and inner ducting
- Steering wheel quick release
- Spare wheel carrier with quick release system
- Tools kit and supports



CIVIC TYPE R

7. ELECTRONICS

- ◇ Engine Control Unit (ECU) EFI Euro 4, including closed loop VTC control, VTEC control
- ◇ Custom made engine harness
- ◇ Custom made, wiring loom (original car wiring is totally removed,
- ◇ Repositioning of all switches on custom made carbon fiber consoles, on dashboard and on tunnel.
- ◇ Digital display, with CAN communication line with ECU. The display integrates the shift lights, mounted on a custom made carbon fiber support.
- ◇ Digital gear indicator

OPTIONS:

- CAN interface cable, software for programming and data analysis
- Data logger wiring loom and sensors (wheel speeds, brake pressures)
- Fuel and oil pressure, lambda, wiring loom and sensors

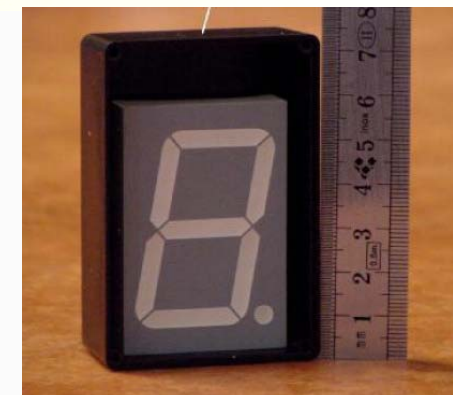

8. FUEL SYSTEM

- ◇ Original fuel tank, located in the original position (below cabin floor panel).
- ◇ Aero quality hoses and couplings

OPTION: Upgraded fuel system including:

- ◇ BOSCH Racing High pressure pump
- ◇ High pressure fuel filter
- ◇ Fuel pressure regulator
- ◇ Competition fuel rail for fuel recirculation
- ◇ 2 lift pumps
- ◇ FIA couplings for quick refilling

FT3 TANK, 80 lts CAPACITY



9. MISCELLANEOUS (INCLUDED)

- ◇ SPEEDLINE RACING wheels, cast aluminum, 7"x17"
- ◇ Automatic fire extinguisher system
- ◇ Handy fire extinguisher
- ◇ Competition battery, positioned in cockpit
- ◇ Sump guard, fuel tank guard in composites



10. OTHER SERVICES

- **Training at JAS Motorsport**

The customer is allowed to send one or more of his technicians and/or mechanics to assist and contribute to the final assembly of the car, for training purposes. The suggested duration of the training is one week before shake down.

Traveling and accommodation of this personnel is at customer charge.

This service is highly recommended to the customer.

- **Debugging, trouble shooting and technical assistance at Customer' site**

Upon request and extra cost, JAS Motorsport will send one of their technicians to assist the customer Racing Team for the initial tests or the first race, to speed up the debugging of the car, to help the team to know quicker and better how to service the car, how to improve the performances and how to solve the possible technical problems.

This service is also highly recommended to the customer.

- **Race Engineering (OPTION)**

Upon request, JAS Motorsport may assist their customers during the test session or race events worldwide.

Skilled technician will help the Team to familiarize with the car, find the best set-up and solve quickly eventual technical problems (troubleshooting)

► CUSTOMER SERVICE

JAS Motorsport provides, to all their customer, a 'hot line technical service', free of charge. In any time during the day or the week-end the Customer may call JAS specialist to ask for assistance or trouble shooting tips.

• **Warranty and general terms**

The parts are not covered by any technical warranty. In case of failure or malfunction, these spares may be replaced free of charge in case of evident and unquestionable manufacturing defects. Parts damaged during shipment are not covered by any warranty and will not be replaced.

• **Permitted use**

The parts supplied by JAS Motorsport are not homologated for road use and must be employed exclusively in races or track day events taking place at tracks designated for that purpose, or in rallies on closed public highways, together with incidental use on the public highway for the purpose of travel between stages of such rallies.

• **Liability**

JAS Motorsport is not responsible for safety incidents, meaning any incident involving death, personal injury or damage to property that may occur, or has occurred, as a result of the use of the vehicle (incorporating JAS Motorsport parts) on the public highway or elsewhere, including, without limitation, the race track.

Parts will be provided free of charge in case that JAS Motorsport admit their responsibilities for poor engineering or manufacturing.

JAS Motorsport is not responsible for any damage or injury to the driver or other people which might occur during the use of the race car. The use of the race car is under the sole responsibility of the Purchaser.

11. SALES CONDITIONS

HONDA CIVIC TYPE R FIA Gr.R, UPGRADING KIT (INSTALLED), as per above description

• Net Price (taxes excluded):.....95.000,00 euro

• Donor car is not included, it may be brought by the Customer or purchased at JAS Motorsport (Net Price 21.500,00 – VAT excluded if due)

• TOP SPECS OPTIONS (see items marked with  at next page):10.000 euros

• **Payment terms:** 30 % with the purchase order
 40% one month before delivery
 30% prior to delivery

All payment by irrevocable bank transfer upon presentation of invoice

• **Delivery:** ex JAS Motorsport works, packing excluded

• **Delivery time:** to be confirmed, normally 16 weeks *from P.O. and downpayment*

• **Offer Validity:** 30 days from receipt of present document

12. PRICE OF MAIN OPTIONS - NOT INCLUDED AS FIRST EQUIPMENT (prices are valid if option is purchased with car)

CODE	DESCRIPTIONS		PRICE REBATED
1000	CHASSIS		€
CTR-103	Lightweight chassis (extra cost)		3.800,00
CTR - 1002	EXT/INT PAINTING - two colours		1.600,00
2000	ENGINE		
RRC-01	set of pistons (4 pieces) - Gr.R EVO 2008		1.324,00
3000	ELECTRONICS AND WIRING		
CCR-3002	EURO 4 interface cable, Programming and analysis SW		980,00
ELE-CAB-CIV-DL	Data logger wiring (w/speeds, brakes, g/box)+brake pressure sensors		1.469,65
ELE-CAB-CIV-P	Oil and fuel pressure kit		576,00
OB6312	Lambda sensor		635,55
6000	COOLING SYSTEM		
MR 373972	KIT WATER COOLER UPGRADED		950,00

12. PRICE OF MAIN OPTIONS - NOT INCLUDED AS FIRST EQUIPMENT (prices are valid if option is purchased with car)

6500	FUEL SYSTEM		
SFT-41076	KIT FT3 tank (rubber bag, carbon container, catch tank, HP-LP pumps, quick refilling couplings, VDO level gauge, wiring)		6.750,00
	KIT GRAVEL		
	KIT OF SHOCK ABS. FR&RR EXTREMETECH, BRAKES, STEERING ARMS, DRIVESHAFTS, HEAVY DUTY LOWER ARM		11.523,00
8000	FRONT SUSPENSIONS GRAVEL		
#H25-D-112	KIT LOWER ARM HEAVY DUTY (or gravel)		2.850,00
11000	WHEELS		
#H25-H-001 7x17	ALUMINIUM WHEELS 7"x17"		211,50
#H25-H-001- 6x15	ALUMINIUM WHEELS 6"x15"		175,50

12. PRICE OF MAIN OPTIONS - NOT INCLUDED AS FIRST EQUIPMENT (prices are valid if option is purchased with car)

13000	REAR BRAKES		
X95.50.60	KIT REAR BRAKES (callipers,discs,bells,mountings)		1.542,00
13000A	BRAKES ACCESSORIES		
CR-15001-DX/SX	KIT BRAKE DUCTS - BUMPER SIDE		411,35
15000	BODYWORK AND PROTECTIONS		
CCR-15019/019-1	AIR SCOOP, COMPLETE INNER/OUTER		540,00
#H25-C-044	HEATED WINDSCREEN, GLASS+WIRING		1.047,60
CCR-15020-GF	LAMP POD - BONNET - FIBREGLASS		342,00
CCR-15021-DX/SX-GF	LAMP PODS SET - BUMPER - FIBREGLASS		576,00
CCR-15022/15023	EXT. REAR VIEW MIRRORS - CARBON		720,00
16000	INSTRUMENTATION and WIRING		
AIM MXL STR	DIGITAL DISPLAY AIM MX PRO (extra cost)		1.000,00

13. EXCLUSIONS

- ◇ The following is not included, and available upon extra cost:
- ◇ Racing tires (car is delivered on used tires or road tires)
- ◇ Spare wheel
- ◇ Registration for road use
- ◇ Packing, transport to destination, duties



SO YOUNG, SO SUCCESSFUL!

BEST RESULTS IN IRC AND WRC 2007



Luca Betti
1° A7 Class – BARUM RALLY (IRC)



Luca Betti
1° A7 Class – SANREMO RALLY (IRC)

SO YOUNG, SO SUCCESSFUL! BEST RESULTS IN IRC AND WRC 2007



Dani Sola
1° A7 Class – Catalunya RALLY (WRC)



Dani Sola
1° A7 Class – Wales RALLY (WRC)

2007 RESULTS



Event	Champ.	class	O/A Result	Class Result	Finishers	Driver
Fiat Turkish Rally	IRC	A7	21°	1°	37	Betti
Ypres Rally	IRC	A7	Ret.	Ret.	60	/
Russia Rally	IRC	A7	Ret.	Ret.	51	/
Rally Vinho Madeira	IRC	A7	15°	1°	36	Solà
Barum Rally Zlin	IRC	A7	22°	1°	48	Betti
Rally di Sanremo	IRC	A7	30°	1°	64	Betti
Catalunya Rally	WRC	A7	20°	1°	65	Solà
Valais Rally	IRC	A7	5°	1°	63	Betti
Wales Rally	WRC	A7	44°	1°	83	Solà



JAS Motorsport s.r.l.

Via Guido Rossa, 1/A – 20010 ARLUNO (ITALY)
Tel. +39.02.90.37.541 – Fax +39.02.90.37.54.215
www.jasmotorsport.com – info@jasmotorsport.com